

イ 仮182-3(1/2)
□ 181-12(1/2)

- 6 6・3 2 5

- 7 0・7 5 0

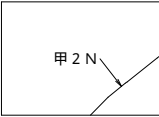
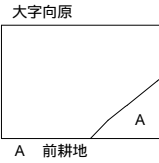

		R ⁵ 41 - 2
	R ⁵ 41 - 3	R ⁵ 41 - 4

- 7 0・8 7 5

- 6 6・5 0 0

山 R ⁵ 41 - 1	2025・01調査
1 : 500	2025・02測図

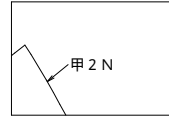
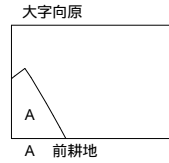

R ⁵ 41 - 1		
R ⁵ 41 - 3	R ⁵ 41 - 4	

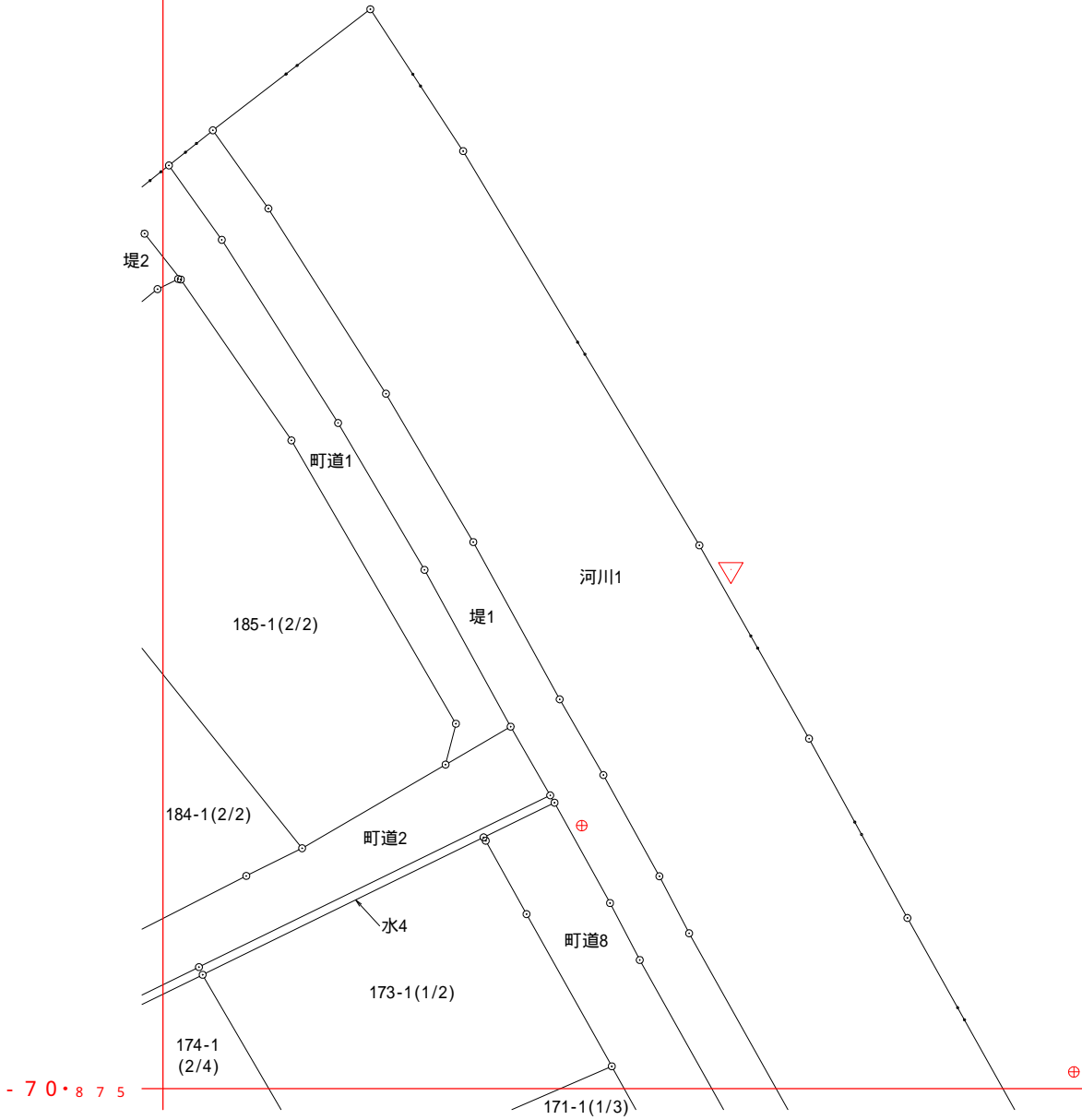

イ 仮182-3(2/2)
ロ 179-3
ハ 98-3
ニ 98-17
ホ 98-24
ヘ 98-23

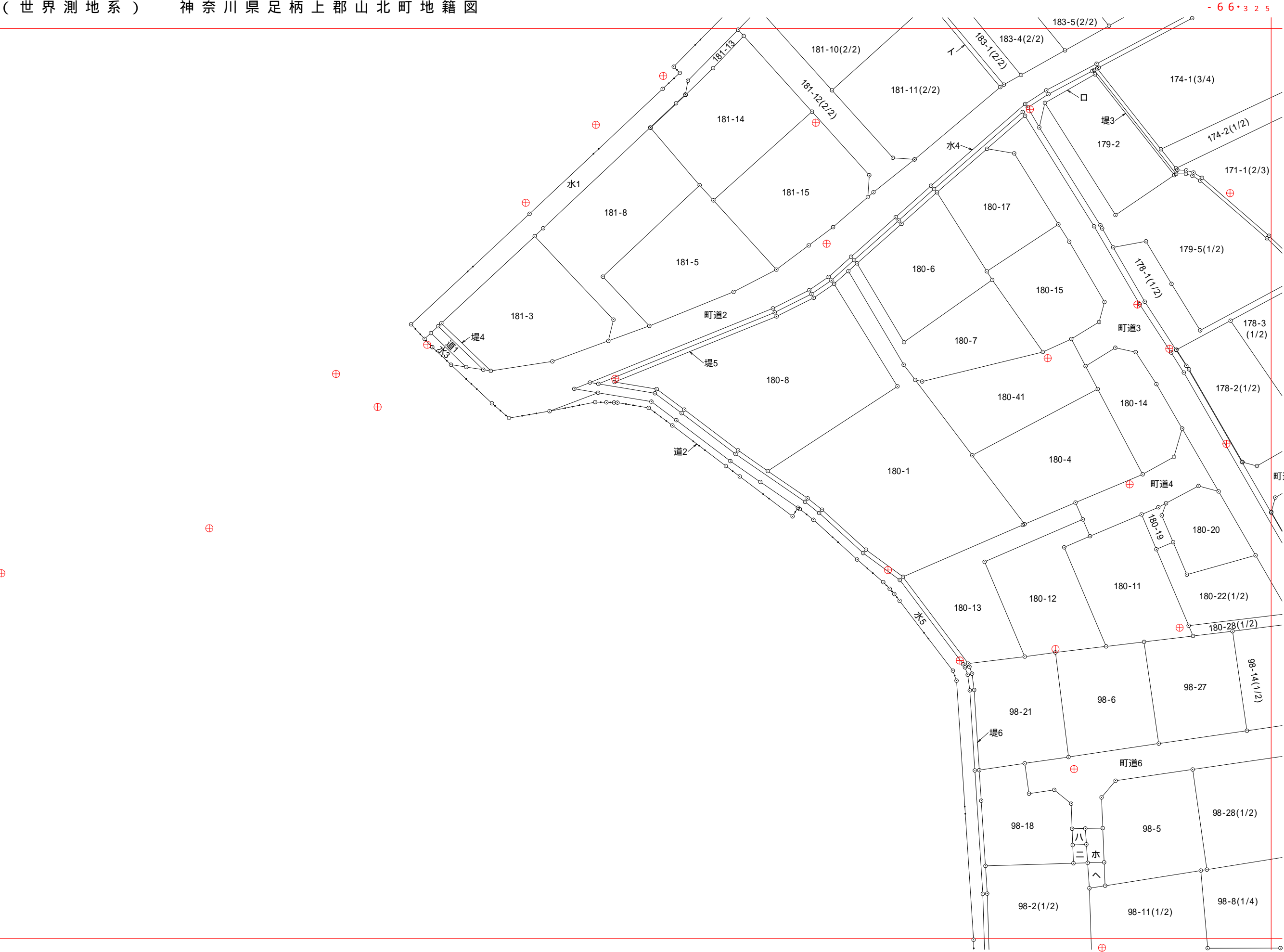

	R ⁵ 41 - 1	R ⁵ 41 - 2
	<div></div>	R ⁵ 41 - 4
	R ⁵ 51 - 1	R ⁵ 51 - 2

イ 178-1(2/2)
ロ 180-28(2/2)
ハ 106-6
ニ 仮158-4
ホ 148-4
ヘ 148-1(1/2)
ト 154-2(1/2)
チ 154-1(1/2)
リ 154-3(1/2)

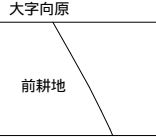

R ⁵ 41 -1	R ⁵ 41 -2	
R ⁵ 41 -3		
R ⁵ 51 -1	R ⁵ 51 -2	

イ 92-4

- 6 6・3 2 5
- 7 1・0 0 0

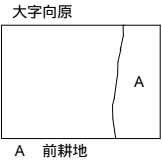

	R ⁵ 41 - 3	R ⁵ 41 - 4
	<div></div>	R ⁵ 51 - 2
	R ⁵ 51 - 3	R ⁵ 51 - 4

- 7 1・1 2 5
- 6 6・5 0 0

山 R ⁵ 5 1 - 1	2 0 2 5・0 1 調査
1 : 5 0 0	2 0 2 5・0 2 測図

- 7 1・2 5 0

- 6 6・5 0 0

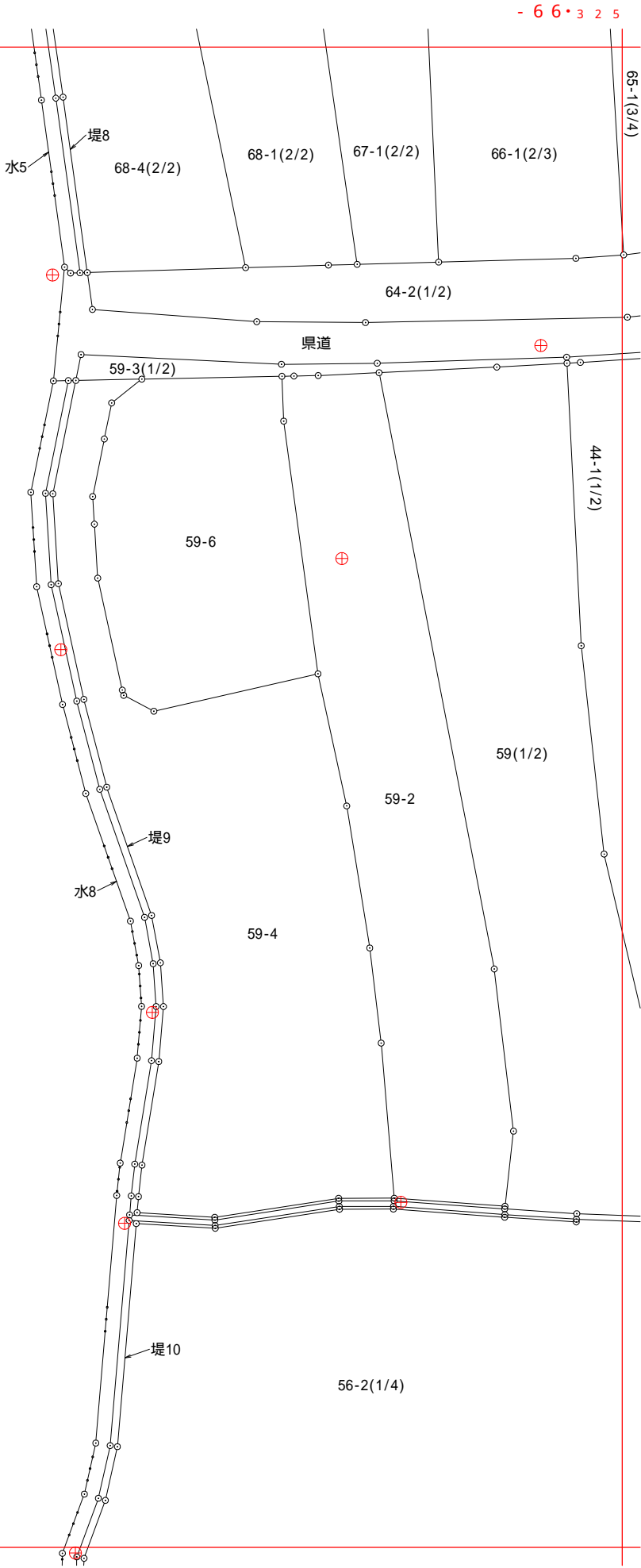

- 6 6・3 2 5

- 7 1・1 2 5

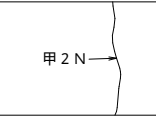
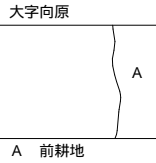

	R ⁵ 5 1 - 1	R ⁵ 5 1 - 2
		R ⁵ 5 1 - 4
	A ⁶ 1 1 - 1	A ⁶ 1 1 - 2

イ 150-6(2/2)
口 仮111-2(2/2)
ハ 123-2
ニ 123-4
ホ 1-6
ヘ 59-3(2/2)
ト 1-11
チ 1-12
リ 17-2
又 仮17-53(1/2)
ル 17-1(1/2)
ヲ 134-2(1/2)
ワ 仮130-6(1/2)

大字向原
前耕地

甲 2 N

R ⁵ 51 - 1	R ⁵ 51 - 2	
R ⁵ 51 - 3		
A ⁶ 11 - 1	A ⁶ 11 - 2	A ⁶ 12 - 1

- 6 6・3 2 5

- 7 1・2 5 0

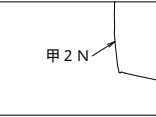
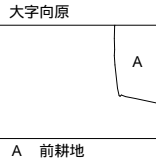

	R ⁵ 51 -3	R ⁵ 51 -4
		A ⁶ 11 -2
		A ⁶ 11 -4

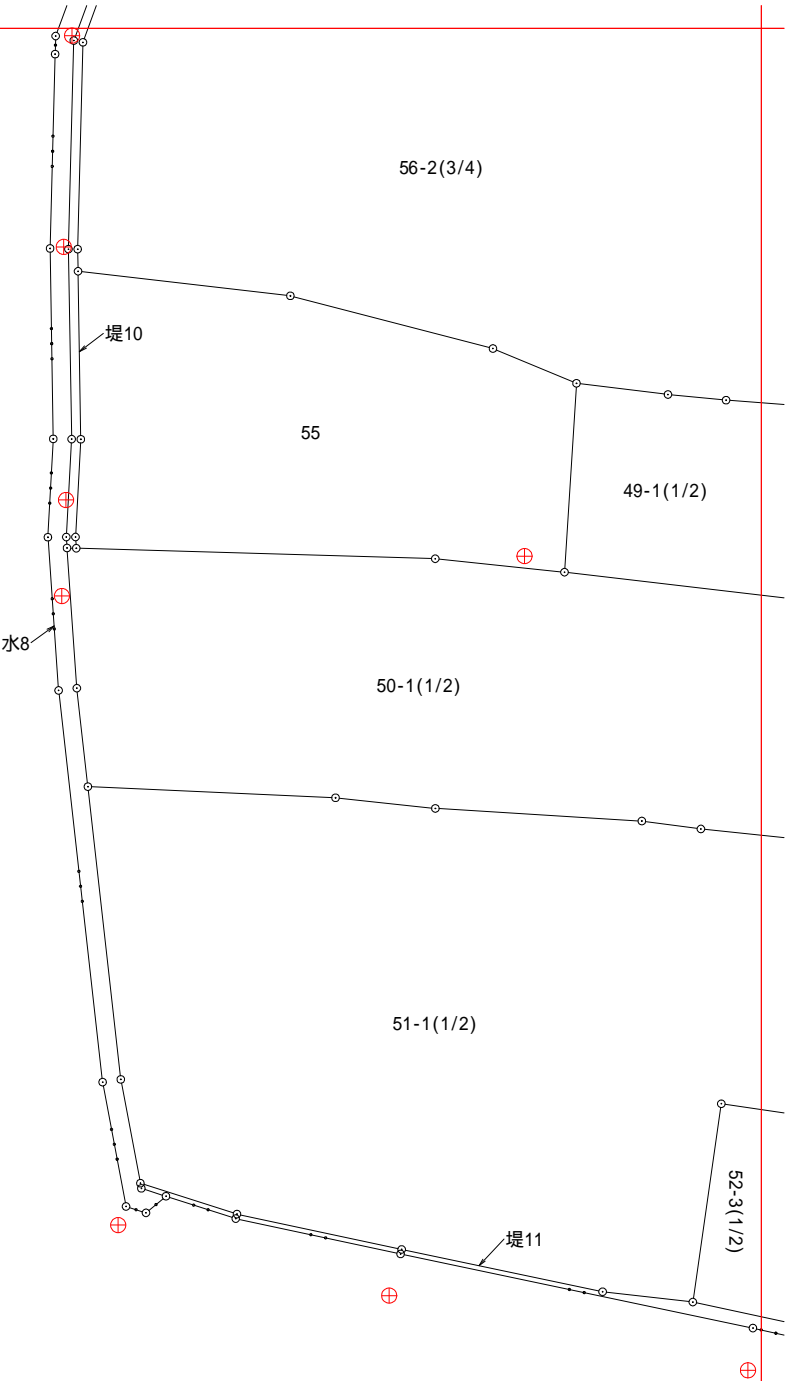

- 7 1・3 7 5

- 6 6・5 0 0

(世界測地系) 神奈川県足柄上郡山北町地籍図

イ 仮17-53(2/2)
 口 仮130-6(2/2)
 八 仮130-5
 二 仮130-7
 ホ 16-2
 ヘ 17-8
 ト 仮56-3
 チ 17-15
 リ 17-17
 ヌ 17-36(1/3)

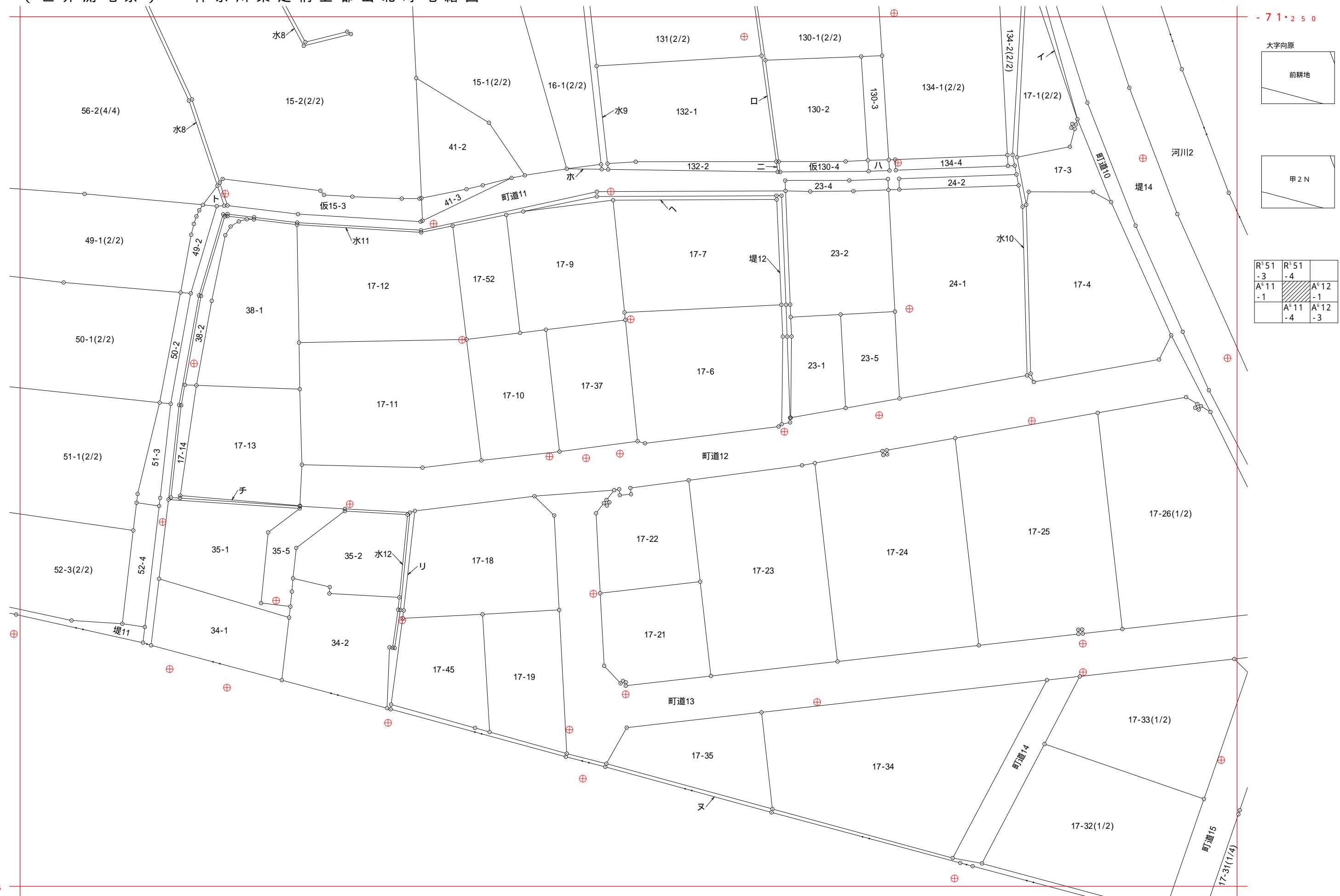

$R^5 51$ -3	$R^5 51$ -4	
$A^6 11$ -1		$A^6 12$ -1
	$A^6 11$ -4	$A^6 12$ -3

大字向原

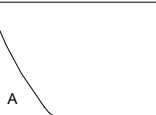

A 前耕地

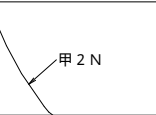

甲 2 N

R ⁵ 51 -4		
A ⁶ 11 -2		
A ⁶ 11 -4	A ⁶ 12 -3	

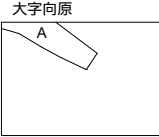
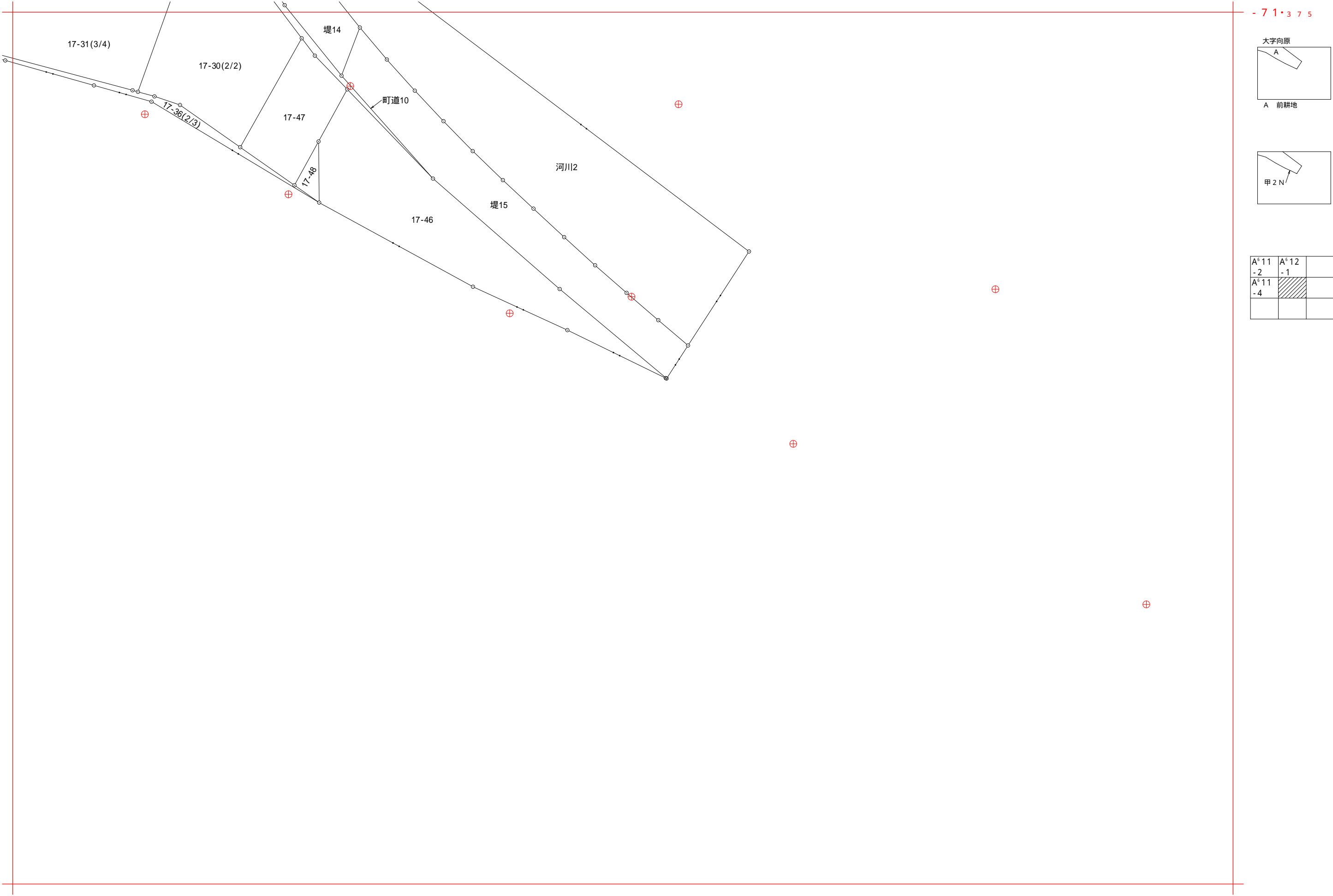

A 前耕地

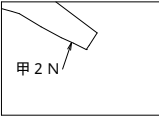

甲 2 N

A ⁶ 11 - 2	A ⁶ 12 - 1	
A ⁶ 11 - 4		

イ 17-36(3/3)

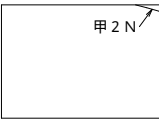
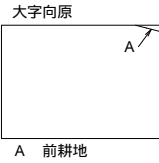
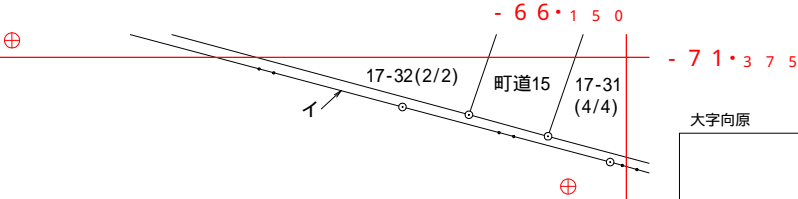

A ⁶ 11 - 1	A ⁶ 11 - 2	A ⁶ 12 - 1
		A ⁶ 12 - 3

- 7 1・5 0 0

- 6 6・3 2 5